

- 1 AQUATICS SERVICE DESK
- 2 OFFICE
- 3 WOMEN'S LOCKER ROOM
- 4 MEN'S LOCKER ROOM
- 5 FAMILY CHANGING ROOM
- 6 SAFETY CENTER
- 7 6-LANE X 25M LAP POOL
- 8 DIVING WELL
- 9 SPA
- 10 POOL FILTER ROOM
- 11 STORAGE

WATER TEMPERATURE:
 6-LANE X 25M LAP POOL= 78 - 83 F
 SPA= 103-104 F

EXISTING POOL AREA FLOOR PLAN

RESTON COMMUNITY CENTER POOL STUDY

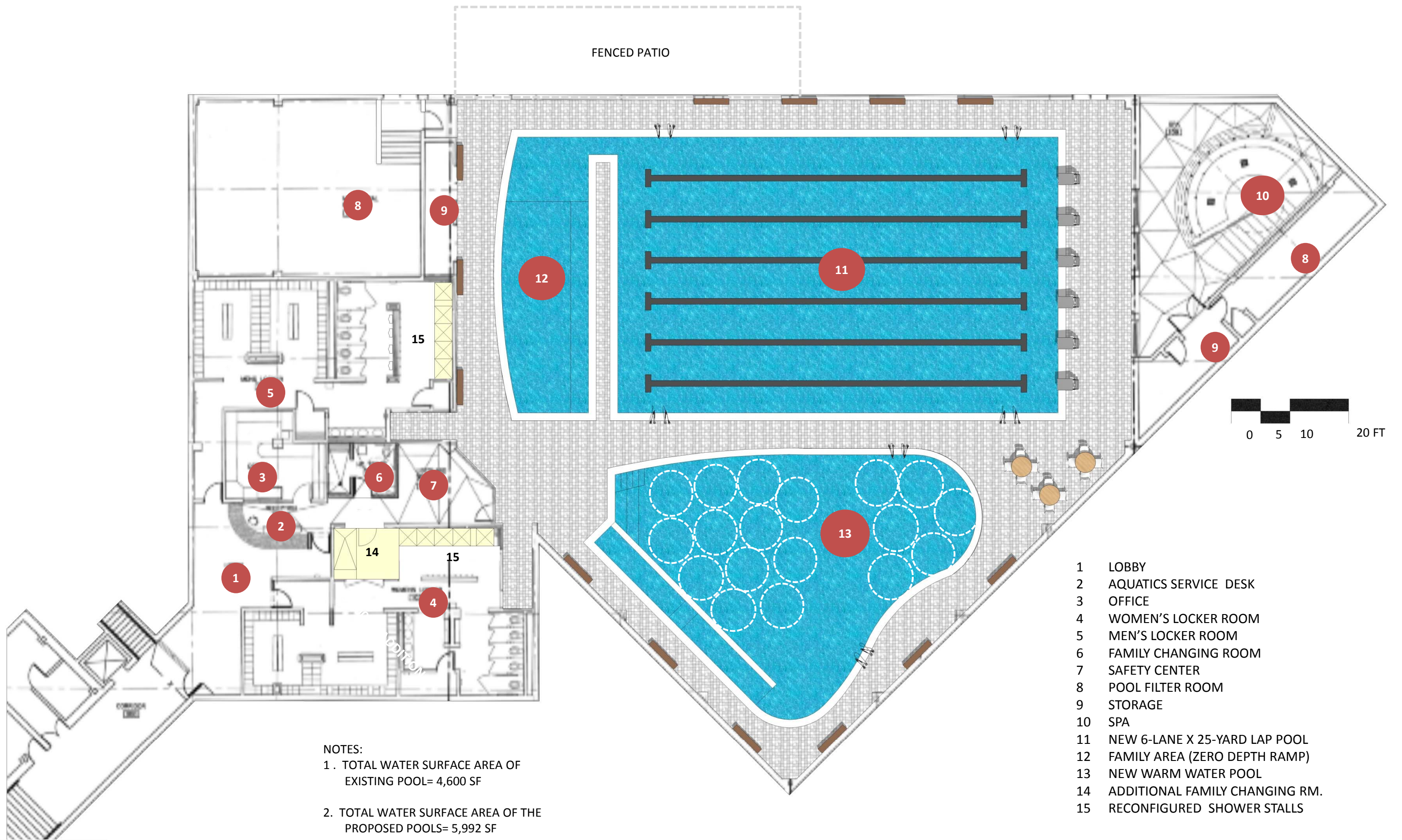

FENCED PATIO

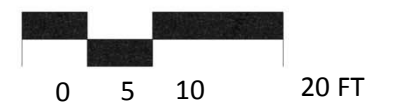

NOTES:
 1. TOTAL WATER SURFACE AREA OF EXISTING POOL= 4,600 SF
 2. TOTAL WATER SURFACE AREA OF THE PROPOSED POOLS= 5,992 SF

- 1 LOBBY
- 2 AQUATICS SERVICE DESK
- 3 OFFICE
- 4 WOMEN'S LOCKER ROOM
- 5 MEN'S LOCKER ROOM
- 6 FAMILY CHANGING ROOM
- 7 SAFETY CENTER
- 8 POOL FILTER ROOM
- 9 STORAGE
- 10 SPA
- 11 NEW 6-LANE X 25-YARD LAP POOL
- 12 FAMILY AREA (ZERO DEPTH RAMP)
- 13 NEW WARM WATER POOL
- 14 ADDITIONAL FAMILY CHANGING RM.
- 15 RECONFIGURED SHOWER STALLS



RESTON COMMUNITY CENTER POOL STUDY

March 13, 2017

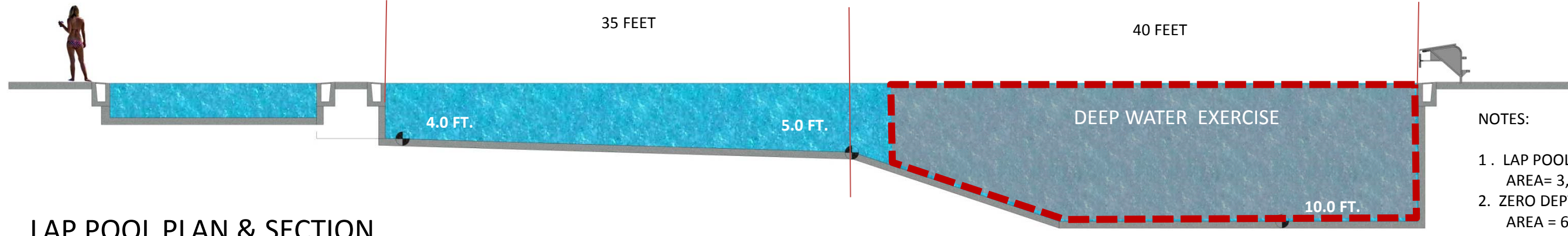

LAP POOL PLAN & SECTION

- NOTES:
- 1. LAP POOL WATER SURFACE AREA= 3,525 SF
 - 2. ZERO DEPTH WATER SURFACE AREA = 6,667 SF
 - 2. WATER TEMPERATURE= 82F

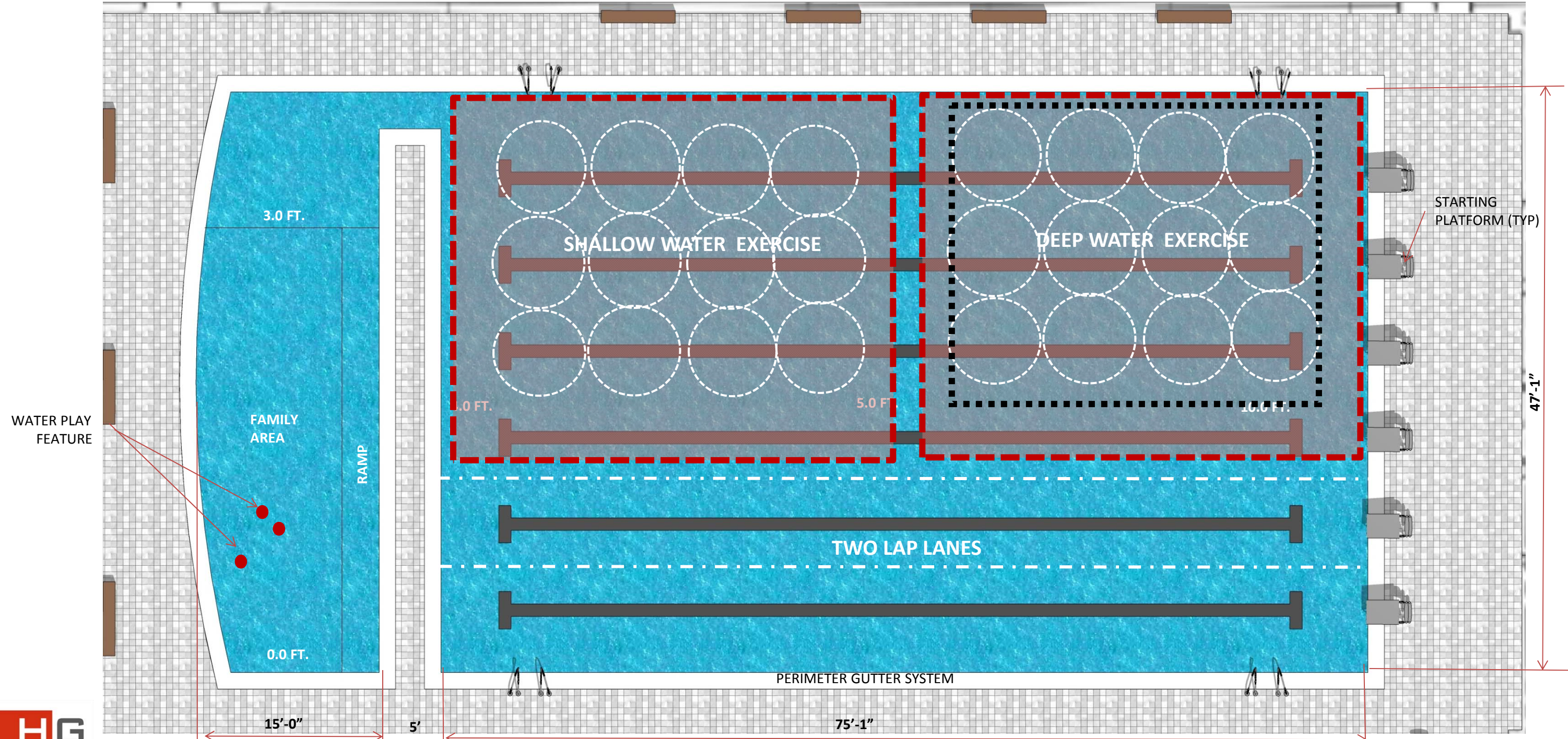
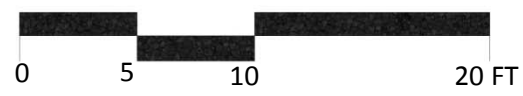

RESTON COMMUNITY CENTER POOL STUDY

March 13, 2017



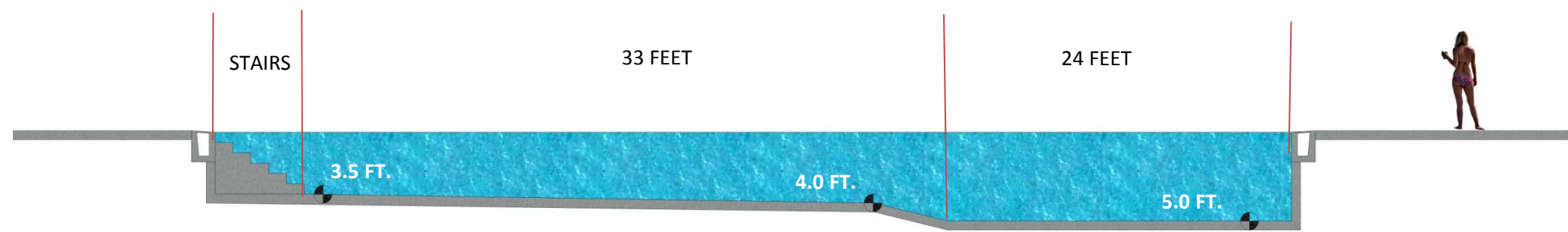

WARM WATER POOL PLAN & SECTION

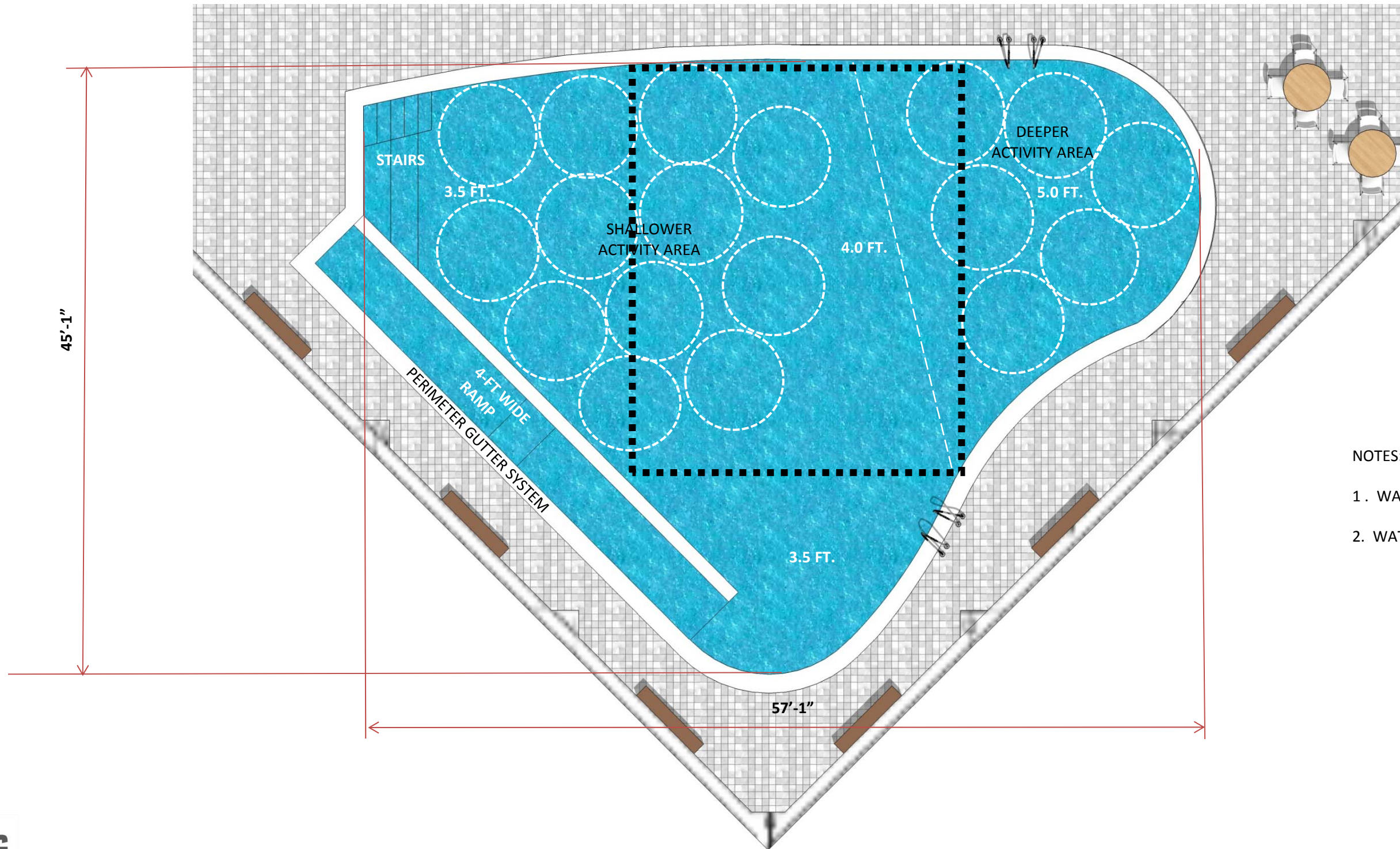
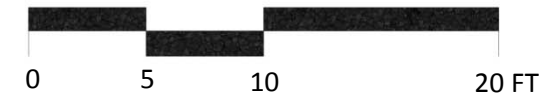

NOTES:

- 1. WARM WATER SURFACE AREA= 1,800 SF
- 2. WATER TEMPERATURE= 85F